

## Event Exeter Venues

# Xfi Building

The **Xfi Building** is part of the Business School at the University of Exeter and offers a variety of comfortable rooms and high tech facilities ideally suited to training, seminars and conferences. All the rooms are equipped with advanced audio visual systems and telephone

and video conferencing facilities are also available. The licensed café in the Atrium is light and airy with a patio area and is available to hire in the evenings for buffets and drinks receptions.

| Facilities at a Glance        |         |           |           |            |
|-------------------------------|---------|-----------|-----------|------------|
|                               | Theatre | Boardroom | Classroom | Receptions |
| The Henderson Lecture Theatre | 180     | –         | –         | –          |
| Conference Room 1             | 40      | 20        | 16        | 30         |
| Conference Room 2             | 40      | 20        | 16        | 30         |
| Seminar Room A                | 25      | 16        | 10        | 20         |
| Seminar Room B                | 25      | 16        | 10        | 20         |
| Seminar Room C                | 20      | 14        | 8         | 15         |
| Atrium                        | –       | –         | –         | 150        |

| The Henderson Lecture Theatre |   |
|-------------------------------|---|
| Fixed tiered lecture theatre  | 180 maximum number  |
| Heating                       | Thermostatically controlled heating   |
| Lighting                      | Ceiling lights with dimmers controlled from lectern, limited natural light without blackouts, LED floor lights  |
| Ventilation                   | Air conditioned   |
| Flooring                      | Carpet  |
| Fire Exits                    | Fire Exit to the grounds outside and through main access doors to the corridor  |
| Built in equipment            | <ul style="list-style-type: none"> <li>• 2 Screens • Computer • 2 Data Projectors • 2 Slide Projectors</li> <li>• DVD Player • VCR Player • Document Cams (Digital OHP)</li> <li>• Power points and Data Ports at every seat</li> <li>• Microphone with Lectern • Video Conferencing Equipment</li> </ul> |
| Accessibility                 | Space for six wheelchairs in front  |





Event Exeter Venues  
**Xfi Building**

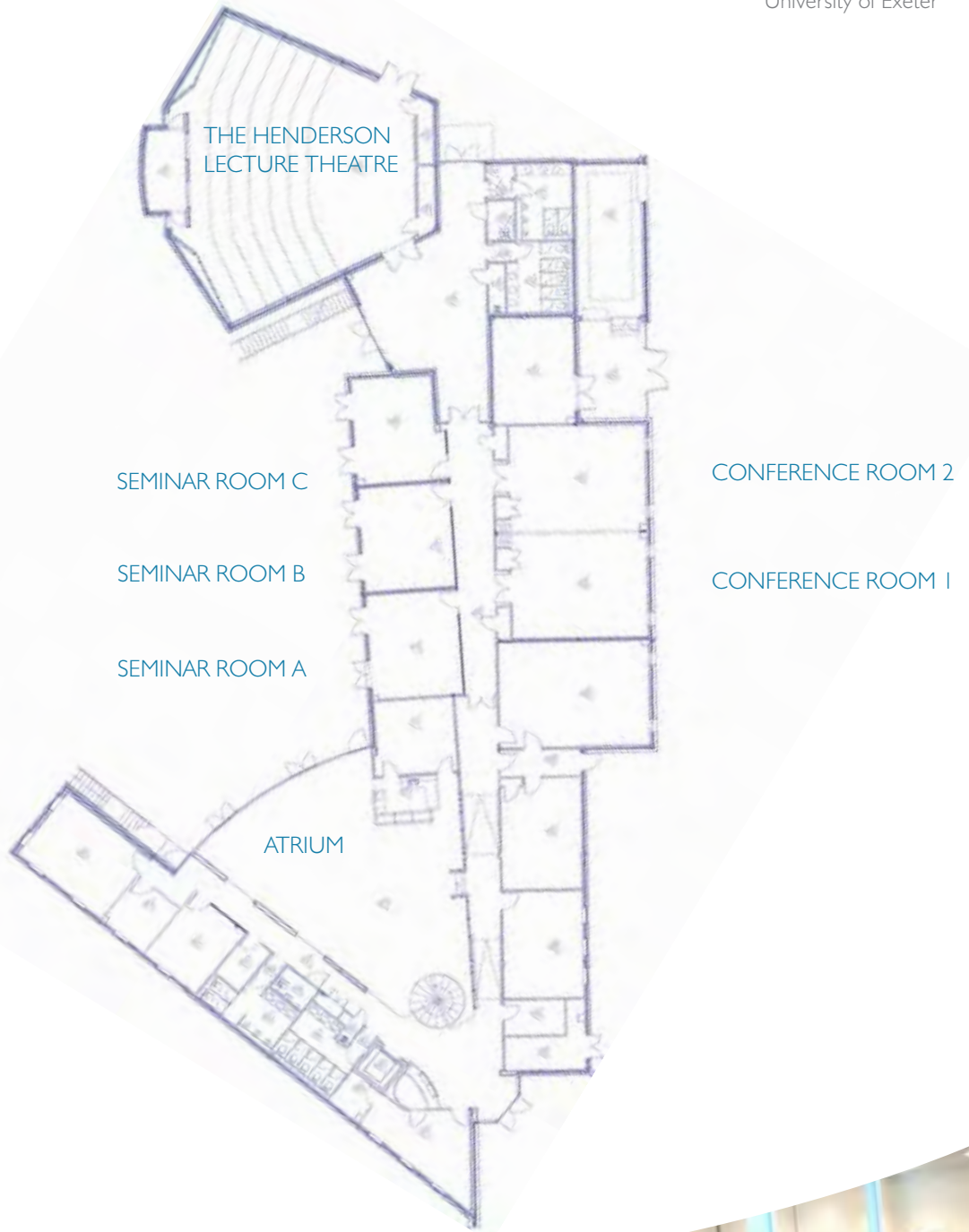

| Conference Room 1 and 2      |  |
|------------------------------|--|
| Flat floored lecture theatre | 40 maximum number  |
| Usable floor area            | 43sq m with fixed lectern  |
| Heating                      | Thermostatically controlled heating  |
| Lighting                     | Ceiling lights with dimmers and natural light with blinds  |
| Ventilation                  | Air Conditioned  |
| Flooring                     | Carpet   |
| Fire Exits                   | Through main access door to corridor   |
| Built in equipment           | <ul style="list-style-type: none"> <li>• Screen • Computer • Data Projector • DVD Player • VCR Player</li> <li>• Sky Digibox • 2 wall mounted flip charts • 2 whiteboards</li> </ul> |
| Accessibility                | All chairs are movable due to the flat floor in this area. Wheelchair seating can therefore be arranged in line with the organiser's requirements.                                   |

Conference Rooms 1 and 2 have a dividing wall which may be folded back to provide flat floored lecture theatre style seating for up to 80 delegates. The AV equipment can be connected to provide 2 screens showing the same information.

| Seminar Room A               |  |
|------------------------------|--|
| Flat floored lecture theatre | 25 maximum number  |
| Usable floor area            | 29sq m with large touch screen in one corner   |
| Heating                      | Radiators  |
| Lighting                     | Fluorescent ceiling lights and wall lights   |
| Ventilation                  | Glass doors and windows open if required   |
| Flooring                     | Carpet   |
| Fire Exits                   | Fire Exit through access door to corridor  |
| Built in equipment           | <ul style="list-style-type: none"> <li>• Smartboard • Computer • DVD Player</li> <li>• VCR Player • Sky Digibox</li> <li>• Powerpoint, Datapoint and Telephone point in centre of floor</li> </ul> |
| Accessibility                | All chairs are movable due to the flat floor in this area. Wheelchair seating can therefore be arranged in line with the organiser's requirements.   |

| Seminar Room B               |  |
|------------------------------|--|
| Flat floored lecture theatre | 25 maximum number  |
| Usable floor area            | 29sq m   |
| Heating                      | Radiators  |
| Lighting                     | Fluorescent ceiling lights and wall lights   |
| Ventilation                  | Glass doors and windows open if required   |
| Flooring                     | Carpet   |
| Fire Exits                   | Fire Exit through access door to corridor  |
| Built in equipment           | <ul style="list-style-type: none"> <li>• Smartboard • Computer • DVD Player</li> <li>• VCR Player • Sky Digibox</li> <li>• Powerpoint, Datapoint and Telephone point in centre of floor</li> </ul> |
| Accessibility                | All chairs are movable due to the flat floor in this area. Wheelchair seating can therefore be arranged in line with the organiser's requirements.   |

| Seminar Room C               |   |
|------------------------------|---|
| Flat floored lecture theatre | 20 maximum number   |
| Usable floor area            | 27sqm L shaped  |
| Heating                      | Radiators   |
| Lighting                     | Fluorescent ceiling lights and wall lights  |
| Ventilation                  | Glass doors and windows open if required  |
| Flooring                     | Carpet  |
| Fire Exits                   | Fire Exit through access door to corridor   |
| Built in equipment           | <ul style="list-style-type: none"> <li>• 2 wall mounted white boards • Computer • Drop down screen • DVD Player • VCR Player • Sky Digibox</li> <li>• Powerpoint, Datapoint and Telephone point in centre of floor</li> </ul> |
| Accessibility                | All chairs are movable due to the flat floor in this area. Wheelchair seating can therefore be arranged in line with the organiser's requirements.  |